

# TIBURON HEAD BOTTOM

19FEB2019

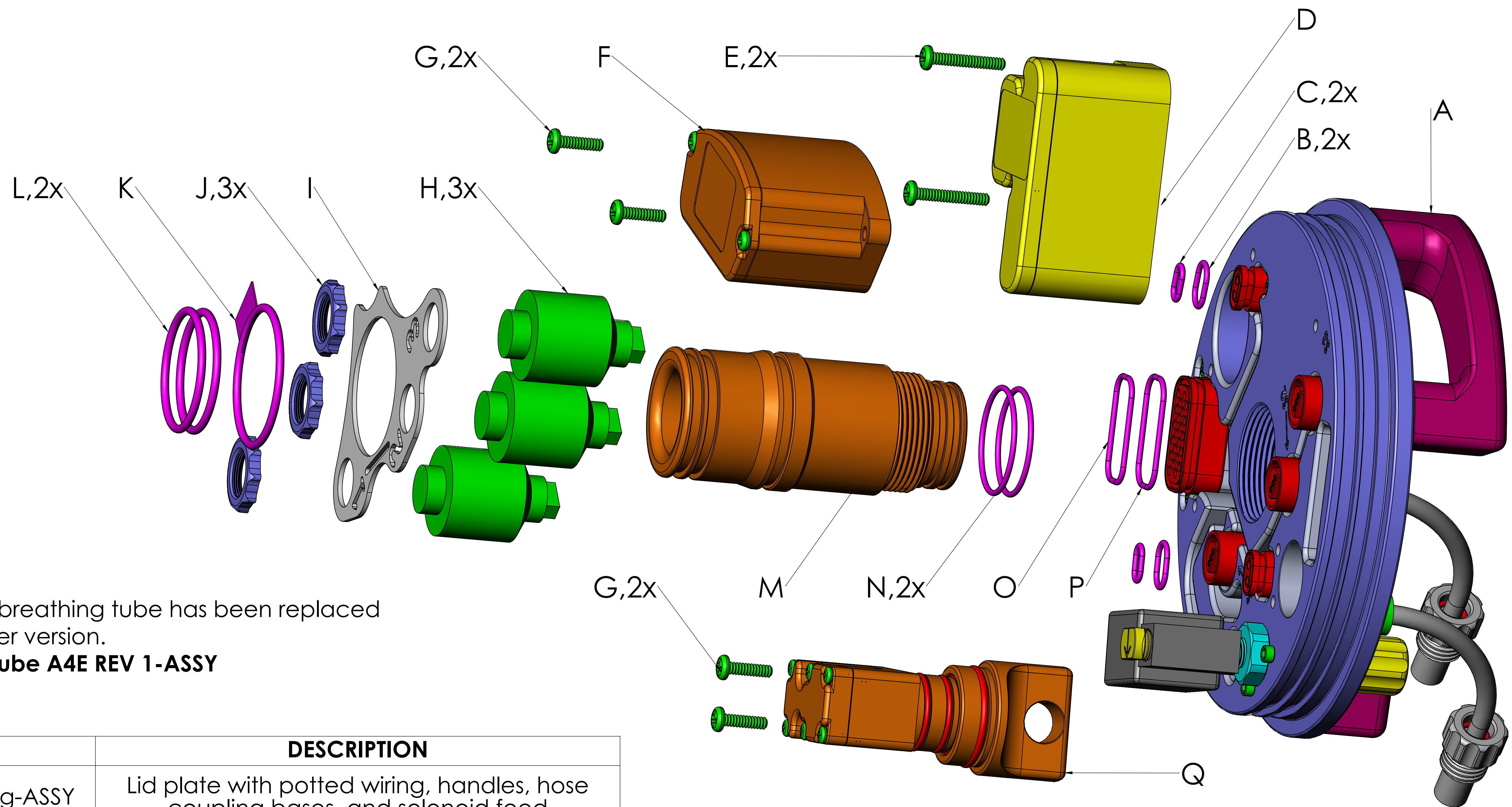

NOTE: The breathing tube has been replaced with a newer version.  
**ML-Inhale tube A4E REV 1-ASSY**

	ISC p/n	DESCRIPTION
A	TML-Lid Tiburon w/ wiring-ASSY	Lid plate with potted wiring, handles, hose coupling bases, and solenoid feed
D	EM-Elect. Mod Tib-ASSY	Complete SOLO and OBOE electronics module with lid
F	BB-Meg15/Tiburon-ASSY	Complete double 9V battery box with lid
H	SC-O2 sensor ISC	Oxygen sensor for ISC products
I	SC-Plate Tiburon	Steel plate to hold sensors in place
J	SC-Nut O2 sensor PF-MP	Nut to hold sensors to steel plate
M	SEE NOTE	Tube adapter to connect head to scrubber top
Q	TBB-HUD Batt box-ASSY	Complete battery box for single 3.6V AA battery to power the HUD

	ISC p/n	DESCRIPTION
B	OR-011	Face seal on battery connections
C	OR-012	Radial seal on battery connections
E	FST-Screw SA/BB/2.5 base	#8-32 x 3/4" phillips panhead steel screw
G	FST-Screw ML	#8-32 x 5/8" phillips panhead steel screw
K	OR-130	Sensor carriage plate hold-down, with tab
L	OR-127	Seals inhale tube to scrubber top
N	OR-025	Seals inhale tube to head plate
O	OR-023	Face seal on computer connections
P	OR-024	Radial seal on computer connections