

# ML-HEAD MEG15 STRIPPED-ASSY

MARCH 30, 2018

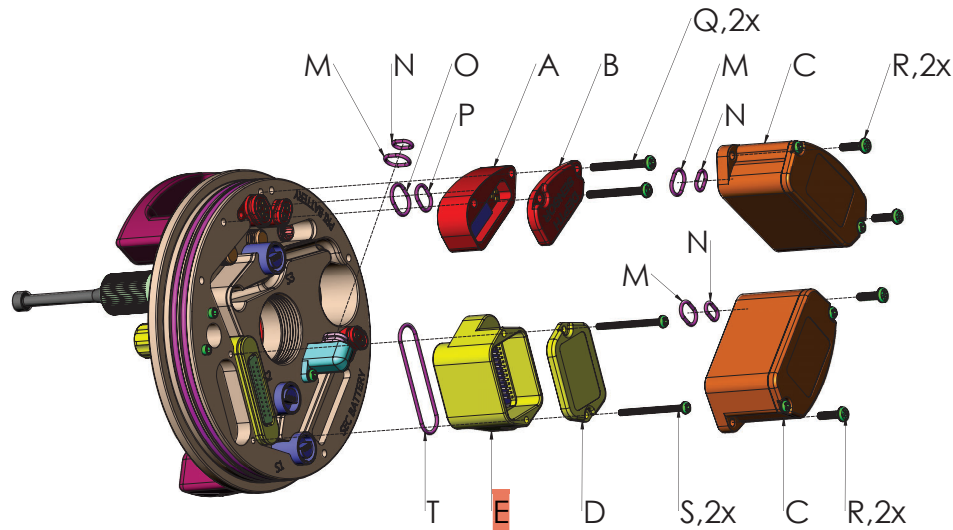

		REV
A	DS-MODULE MEG 15-ASSY	
B	DS-LID MEG15-MP	0
C	BB-MEGA4E-ASSY	
D	A4E-LID MEG15-MP	0
E	Electronics Module -UNAVAILABLE	
F	O2F-DUST CAP O2 FEED-MP	0
G	O2F-FEED A4E MEG-ASSY	
H	SA-DIFFUSER-MP	0
I	SC-PLATE MEG A4E	0
J	SC-NUT O2 SENSOR PATHFINDER-MP	1
K	Replaced by-ML-Inhale tube A4E REV 1-ASSY	0
L	ML-LID MEG 15-ASSY-UNAVAILABLE	

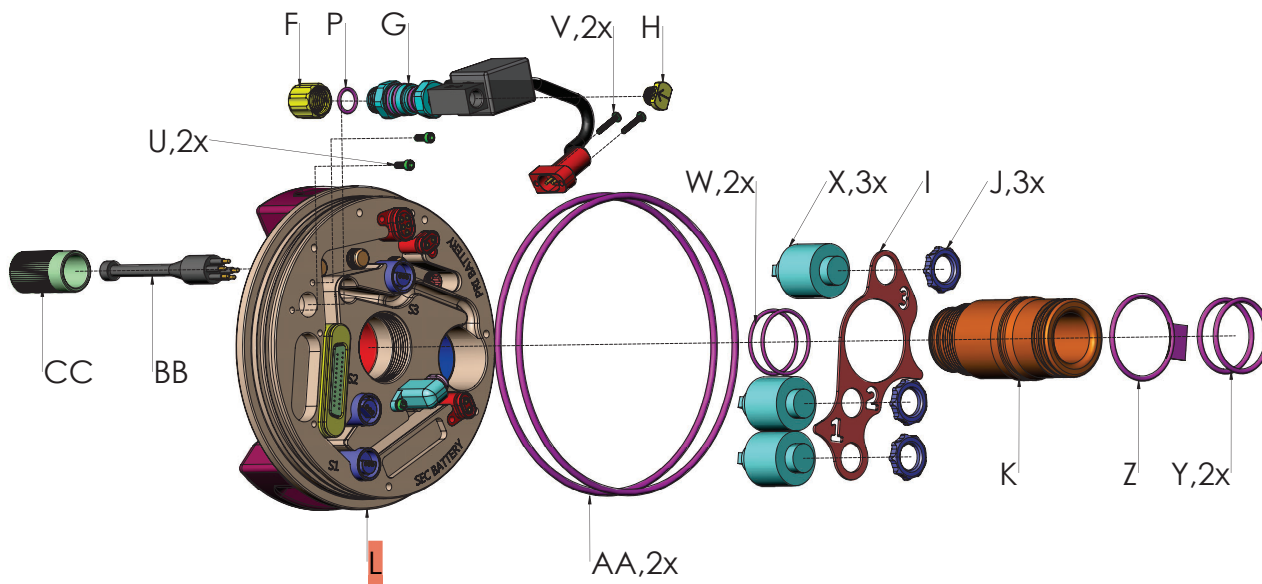

M	OR-012 (radial seal on BB/SOL conn)
N	OR-011 (face seal on BB/SOL conn)
O	OR-014 (radial seal on DS conn)
P	OR-013 (face seal on DS conn)
Q	FST-SCREW DEPTH SENSOR
R	FST-SCREW ML
S	FST-SCREW ELECT BOX A4E MEG
T	OR-029 (radial seal on elect conn)
U	FST-SCREW SOCKET HEAD HS & SC
V	FST-SCREW A4E MEG SOL PLUG
W	OR-025 (inhale tube seal on plate)
X	SC-O2 SENSOR ISC
Y	OR-127 (inhale tube seal on scrubber)
Z	OR-130 (for securing SC plate on tube)
AA	OR-259 (head plate seal to plenum)
BB	A3E-HS DUMMY CAP
CC	A3E-HS LOCKING SLEEVE SeaCon